

Lenco

CD RADIO ALARM CLOCK with remote temperature sensor CR-3304

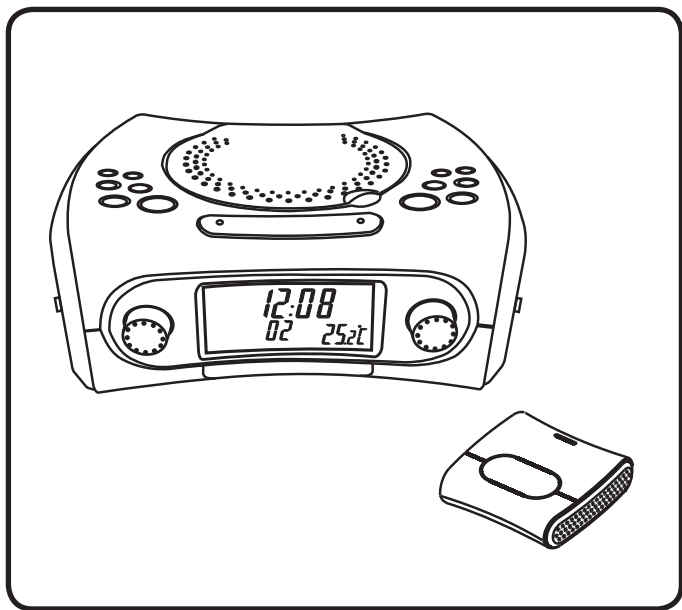

INSTRUCTION MANUAL

For information and support, www.lenco.eu





WARNING

CLASS 1 LASER PRODUCT

CLASS 1 LASER PRODUCT
APPAREIL À LASER DE CLASSE 1
PRODUCTO LASER DE CLASE 1

CAUTION
INVISIBLE LASER RADIATION
WHEN OPEN AND INTERLOCKS
DEFEATED.
AVOID EXPOSURE TO BEAM



This product contains a low power laser device.

Warning: Do not touch the lens.

DO NOT THROW BATTERIES IN FIRE !

PRECAUTIONS

Follow the advice below for safe and appropriate operations.

ON PLACEMENT

- Do not use the unit in places which are extremely hot, cold, dusty, or humid.
- Place the unit on a flat and even surface.
- Do not restrict the air flow of the unit by placing it in a place with poor air flow, by covering it with a cloth, or by placing it on a carpet.

ON SAFETY

- When connecting and disconnecting the AC cord, grip the plug and not the cord itself. Pulling the cord may damage it and create hazard.
- When you are not going to use the unit for a long period of time, disconnect the AC power cord.

ON AC VOLTAGE

- Before use, check that the rated voltage of your unit matches your local voltage.

ON CONDENSATION

- When left in a heated room where it is warm and damp, water droplets or condensation may form inside the CD player.
- When there is condensation inside the unit, the unit may not function normally.
- Let it stand for 1 to 2 hours before turning the power on, or gradually heat the room up and dry the unit before use.
- Ensure a minimum distance of 5 cm around the apparatus for sufficient ventilation.
- Ensure that the ventilation is not impeded by covering the ventilation openings with items, such as newspapers, table-cloths, curtains, etc.
- Do not place naked flame sources, such as lighted candles on the apparatus.
- Take attention to the environmental aspects of battery disposal.
- Use the apparatus only in moderate climates (not in tropical climates).
- Do not expose the apparatus to dripping or splashing.
- Do not place objects filled with liquids, such as vases, on the apparatus.

Should any trouble occur, disconnect the AC power cord and refer servicing to qualified personnel.



The lightning flash with arrowhead symbol within the triangle is a warning sign alerting the user of "dangerous voltage" inside the unit.

CAUTION

RISK OF ELECTRIC SHOCK
DO NOT OPEN

ATTENTION : To reduce the risk of electric shock, do not remove the cover. There are no user serviceable parts inside the unit. Refer all servicing to qualified personnel.



The exclamation point within the triangle is a warning sign alerting the user of important instructions accompanying the product.

In case of malfunction due to electrostatic discharge, the apparatus has to be reset by disconnecting it from mains supply. THE MARKING INFORMATION IS LOCATED AT THE BOTTOM OF APPARATUS.



LOCATION OF CONTROLS

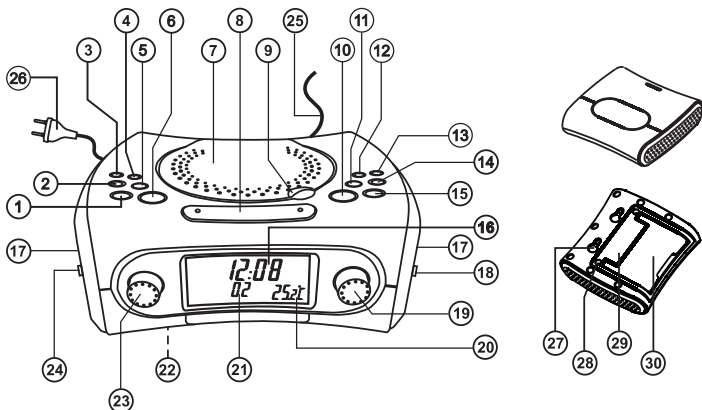

Main unit

- | | |
|----------------------------|-----------------------------|
| 1. Sleep button | 14. Next button ►► |
| 2. Minute Button | 15. Stop button ■ |
| 3. Time button | 16. LCD alarm clock display |
| 4. Alarm button | 17. Speaker |
| 5. Hour button | 18. Alarm switch |
| 6. Power button | 19. Tuning control |
| 7. CD Door | 20. Temperature display |
| 8. Snooze button | 21. CD display |
| 9. CD Door open close area | 22. Battery compartment |
| 10. Play / Pause button ► | 23. Volume control |
| 11. Back button ◀◀ | 24. Function switch |
| 12. Play Mode button | 25. Wire Antenna |
| 13. Program button | 26. 230V power supply cable |

Remote temperature sensor

- 27. Hanger slot
- 28. Screw for mounting battery compartment
- 29. Battery compartment
- 30. Stand

POWER SUPPLY

OPERATION WITH AC POWER

1. PLEASE CAREFULLY CHECK THAT THE VOLTAGE INDICATED ON YOUR SET CORRESPONDS TO THE VOLTAGE OF YOUR LOCAL AREA.
2. INSERT THE AC POWER CORD INTO AN AC OUTLET.

NOTE : WHEN INSERTED A BACK UP BATTERY THE UNIT WILL CONSERVE THE SETTINGS DURING POWER OUTAGE.
THE DISCONNECT DEVICE SHALL REMAIN READILY OPERABLE.

POWER ON AND OFF

PRESS THE POWER BUTTON TO TURN THE UNIT ON OR OFF.

ANTENNA

FOR FM RECEPTION LAY OUT THE EXTERNAL FM WIRE ANTENNA AND ADJUST DIRECTION, FOR OPTIMUM RECEPTION.

DO NOT CONNECT THIS WIRE TO ANY OUTDOOR ANTENNA.

FITTING THE BATTERIES

BATTERY BACKUP

THE CLOCK TIME AND ALARM SETTINGS CAN BE PROTECTED AGAINST POWER FAILURE BY A 9V BATTERY (NOT SUPPLIED). IN THE EVENT OF A POWER FAILURE , THE DISPLAY IS BLANK , BUT THE CLOCK TIME AND ALARM SETTINGS ARE HELD IN MEMORY. WHEN THE POWER INTERRUPTION ENDS, THE DISPLAY APPEARS AGAIN . (DURING A POWER INTERRUPTION , THE CLOCK TIME MAY GAIN OR LOSS A FEW MINUTES PER HOUR AND MAY REQUIRE RESETTING .)

BATTERY INSERTION

1. REMOVE THE COVER OF THE BATTERY COMPARTMENT (ON THE BOTTOM OF THE UNIT).
2. CONNECT A 9V BATTERY (AN ALKALINE - TYPE BATTERY IS RECOMMENDED) TO THE BATTERY TERMINAL INSIDE THE COMPARTMENT .
3. PLACE THE CONNECTED BATTERY IN THE COMPARTMENT AND REPLACE THE COVER .

FOR OPTIMUM PERFORMANCE , THE BATTERY SHOULD BE REPLACED EVERY 6 MONTHS.

REMOTE TEMPERTURE SENSOR

1. REMOVE THE FOUR SCREWS FROM THE BATTERY COMARTMENT WITH A SCREWDRIVER.
2. INSTALL TWO AAA/LR03 (1.5V) SIZE BATTERIES MATCHING POLARITIES SHOWN IN THE BATTERY COMPARTMENT.
3. TIGHTEN THE SCREW.

NOTE: FOR OPTIMUM , THE BATTERY SHOULD BE REPLACED EVERY 10 MONTHS. OR WHEN THE OUTDOOR READINGS CANNOT BE DISPLAYED PROPERLY.

THE CLOCK

TO SET THE TIME

1. PRESS AND HOLD THE TIME SET BUTTON
2. PRESS THE HOUR BUTTON TO SET HOURS.
3. PRESS THE MINUTE BUTTON TO SET MINUTES.
4. RELEASE THE TIME SET BUTTON. THE CORRECT TIME IS SHOWN ON THE DISPLAY.



TO WAKE TO THE MUSIC

- SLIDE THE ALARM SWITCH TO THE AUTO POSITION , THE SYMBOL "  " IS SHOWN ON THE DISPLAY AND ADJUST THE VOLUME CONTROL TO THE LISTENING LEVEL YOU WANT.
- SELECT THE WAKE-UP SOURCE BY SLIDING THE FUNCTION SWITCH TO (FM ST. /FM MONO/CD).
- IN THE RADIO MODE, THE SELECTED RADIO STATION WILL PLAY.
 - IN THE CD MODE, THE DISC LOADED IN THE CD COMPARTMENT WILL PLAY.
 - IF NO BUTTON IS PRESSED, ALARM WILL LAST FOR 2 HOURS.

WAKE TO ALARM

TO AWAKEN BY ALARM , SET THE ALARM SWITCH TO THE BUZZER POSITION.
THE SYMBOL "  " IS SHOWN ON THE DISPLAY.

SNOOZE (REPEAT ALARM)

WHEN THE ALARM SOUNDS (CD / RADIO / BUZZER) AT THE PRESET TIME ,YOU CAN TURN OFF THE SOUND TEMPORARILY BY PRESSING THE SNOOZE BUTTON . THE SYMBOL " Zz " IS SHOWN ON THE DISPLAY. THE ALARM WILL SOUND AGAIN WITHIN 9 MINUTES . THIS CYCLE CAN BE REPEATED FOR UP TO ONE HOUR.

TO STOP ALARM (CD / RADIO / BUZZER)

SIMPLY SET THE ALARM SWITCH TO OFF OR PRESS THE ALARM BUTTON .
THE SYMBOL "  " DISAPPEAR ON THE DISPLAY.

SLEEP FUNCTION

1. TO FALL ASLEEP WHILE LISTENING TO MUSIC, PRESS THE SLEEP BUTTON.
THE SYMBOL "  " IS SHOWN ON THE DISPLAY.
2. TO ADJUST THE RADIO'S SLEEP FUNCTION TO PLAY FROM 90 , 60, 30 TO 15 MINUTES OF MUSIC BEFORE SHUTTING ITSELF OFF AUTOMATICALLY.

REMOTE TEMPERATURE SENSOR

INSTALL THE REMOTE TEMPERATURE

AFTER INSTALLING THE BATTERIES, POSITION THE REMOTE SENSOR TO DESIRED OUTDOOR LOCATION WITHIN THE EFFECTIVE TRANSMISSION RANGE OF 15 METRE. IT CAN BE MOUNTED ON THE WALL BY USING THE HANGER SLOT AT THE BACK, HANG THE REMOTE SENSOR ON THE WALL WITH THE SCREW.

UNIT STAND

THIS UNIT INCORPORATES A STAND WHICH ALLOWS IT TO BE USED ON A TABLE OR OTHER FLAT SURFACE.

NOTE:

THE SURROUNDING BUILDING MATERIALS AND HOW THE MAIN UNIT AND REMOTE SENSOR ARE POSITION CAN INFLUENCE THE EFFECTIVE TRANSMISSION RANGE.

IT SHOULD BE PLACED AWAY FROM DIRECT SUNLIGHT, RAIN OR SNOW, HIGH POWER ELECTRICAL APPLIANCE AND STRONG MAGNETIC FIELD SUCH AS SPEAKERS.

OUTDOOR

AFTER BATTERIES ARE INSTALLED, THE REMOTE SENSOR WILL TRANSMIT THE OUTDOOR TEMPERATURE AT 15 SECONDS INTERVAL. THE MAIN UNIT MAY TAKE UP TO 15 SECONDS TO RECEIVE THE INITIAL READINGS UPON GOOD SIGNAL RECEPTION. THEN THE MAIN UNIT WILL AUTOMATICALLY UPDATE READINGS AT TWO-MINUTES INTERVAL. IF NO SIGNAL IS RECEIVED FROM THE REMOTE SENSOR AFTER 10 MINUTES , THE OUTDOOR READINGS WILL NOT BE DISPLAYED PROPERLY. YOU SHOULD PLACE THE REMOTE SENSOR CLOSER TO THE MAIN UNIT OR REPLACE THE BATTERIES.



REPEAT , REPEAT ALL AND MIX PLAYBACK

Press PLAY MODE button during stop mode. CD plays with a single track repeat, all tracks repeat or randomly.

FOR NORMAL COMPACT DISC PLAYBACK

Mode sequence REPEAT >> REPEAT ALL >> MIX >> CLEAR.

During Repeat 1 mode,
display shows



During Repeat 2 mode,
display shows



During Mix mode,
display shows

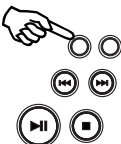

Note on CD-R/RW discs

- Because of non-standardized format definition/ production of CD-R/RW, playback quality and performance are not guaranteed.
- Manufacturer is not responsible for the playability of CD-R/RW due to recording conditions, such as PC performance, writing software, media ability, etc.
- Do not attach a seal or label to either side of the CD-R/RW disc. It may cause a malfunction.
- It is recommended to record only audio files on CD-R/RW discs for easy reading.

PROGRAMMED PLAYBACK

PROGRAMMED PLAYBACK

FOR NORMAL COMPACT DISC PLAYBACK

Programmed playback enables tracks on a disc to be played in a desired order. Up to 20 tracks can be programmed.

1. Press the "PROGRAM" button.
2. Press the "NEXT" and "BACK" buttons to select the desired track number.
3. Press "PROGRAM" button again to memorize the track.
4. Repeat steps 2 and 3 until all desired tracks are programmed.
5. Press the "PLAY/PAUSE" button to start. "▶" & "PROGRAM" are shown on the display.
6. Press "STOP" button to stop programmed playback.
7. Press "PROGRAM" and "PLAY/PAUSE" buttons to resume programmed playback.
8. Open the CD door or turn off the CD player to clear the programmed memory.

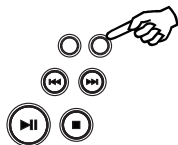

MAINTENANCE

CLEANING A CD

If the CD skips or will not play, the disc may need cleaning. Before playing, wipe the disc from the centre out with a cleaning cloth. After playing, store the disc in its case.



CLEANING THE CD LENS

If the CD lens is dusty, clean it with a brush-blower. Blow several times on the lens and remove the dust with the brush. Finger prints may be removed with a cotton swab moistened with alcohol.

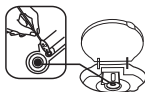

CLEANING THE UNIT

Do not use volatile chemicals on this unit. Clean by lightly wiping with a soft cloth.

IMPORTANT NOTE

If an abnormal display indication or an operating problem occurs, disconnect the AC power cord and remove the batteries. Wait at least 5 seconds, then reconnect the AC power cord or reinstall the batteries.

WARNING

Should the CD door be opened before the reading of the CD is completed, a jamming noise may occur. This is resolved by closing the CD door.

GB 5

SPECIFICATIONS

CD SECTION

Channels:	2 channels
S / N ratio:	60 dB
Wow & Flutter:	undetectable
Sampling frequency:	44.1 kHz 8 x over sampling
Quantization:	1 bit DA converter
Pick up light source:	Semi - conductor laser
Pick up wave length	790 nm

RADIO SECTION

Tuning ranges:	FM 87.5 - 108 MHz
Antennas:	FM Wire Antenna

GENERAL

Output power:	1 W + 1 W (RMS)
Power consumption:	12.5 W
Speaker:	2¼ " 8 OHM
Power source:	AC : 230V ~ 50Hz DC : 9V backup (1 x 006P)
Remote sensor	3V, 2 x AAA/LR03 (1.5V)

Dimensions:	
Main unit	245(L) x 207(D) x 104(H)mm
Remote temperature sensor	80(L) x 76 (D) x 22(H)mm
Weight	1.37KGS

Due to continuing improvement, the features and the design are subject to change without notice.

Where to place the item :

Today's furniture is coated with a wide variety of lacquers and synthetic-coatings that are treated with an extensive range of cleaning products. Therefore, the possibility that some of these substances contain components that react adversely to the rubber feet of the item and soften them, cannot be completely excluded. The rubber feet of the appliance can cause discoloring to furniture surfaces. If necessary, place the appliance on a non-slide surface.



If at any time in the future you should need to dispose of this product please note that : Waste electrical products should not be disposed of with household waste. Please recycle where facilities exist. Check with your Local Authority or retailer for recycling advice. (Waste Electrical and Electronic Equipment Directive)

For information and support, www.lenco.eu